

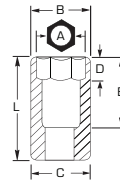

## 3/8" DRIVE SUPER SHORT SOCKETS - 6 POINT

- › Proto 6 Point Sockets can be used on stubborn hex bolts or bolts made from softer materials.
- › Contact stresses are dispersed over a larger area.
- › Risk of rounding the fastener is reduced.
- › Enables users to turn worn, rounded fasteners.



- › Radius-corner socket design
- › Engages flats for better grip
- › Improves the ability to turn worn or rounded fasteners

INCH		Nut End Outside Diameter (in) (B)	Drive End Outside Diameter (in) (C)	Nut Depth (in) (D)	Bolt Clearance Depth (in) (E)	Overall Length (in) (L)	Weight (lbs)
3/16	<b>J5206HS</b>	21/64	43/64	3/16	19/64	3/4	0.04
1/4	<b>J5208HS</b>	25/64	43/64	11/64	19/64	3/4	0.03
5/16	<b>J5210HS</b>	15/32	43/64	9/64	21/64	49/64	0.03
3/8	<b>J5212HS</b>	35/64	43/64	11/64	21/64	51/64	0.04
7/16	<b>J5214HS</b>	39/64	43/64	7/32	7/16	7/8	0.04
1/2	<b>J5216HS</b>	47/64	47/64	17/64	13/32	7/8	0.05
9/16	<b>J5218HS</b>	51/64	51/64	3/8	29/64	57/64	0.17
5/8	<b>J5220HS</b>	55/64	55/64	27/64	33/64	15/16	0.09
11/16	<b>J5222HS</b>	15/16	15/16	15/32	1/2	15/16	0.09
3/4	<b>J5224HS</b>	1	29/32	27/64	1/2	1-1/64	0.11



## 3/8" DRIVE SOCKETS - 8 POINT

- › For square fasteners.

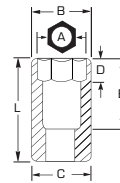

- › Radius-corner socket design
- › Engages flats for better grip
- › Improves the ability to turn worn or rounded fasteners

INCH		Nut End Outside Diameter (in) (B)	Drive End Outside Diameter (in) (C)	Nut Depth (in) (D)	Bolt Clearance Depth (in) (E)	Overall Length (in) (L)	Weight (lbs)
1/4	<b>J5208S</b>	35/34	5/8	1/4	39/64	1-5/64	0.04
5/16	<b>J5210S</b>	9/16	5/8	1/4	39/64	1-5/64	0.05
3/8	<b>J5212S</b>	11/16	11/16	1/4	39/64	1-5/64	0.07
7/16	<b>J5214S</b>	3/4	3/4	17/64	39/64	1-5/64	0.08
1/2	<b>J5216S</b>	7/8	7/8	5/16	21/32	1-1/8	0.12

